

Shark MP200™ in Enclosure

For Three Phase and Single Phase MP200™ Metering Systems

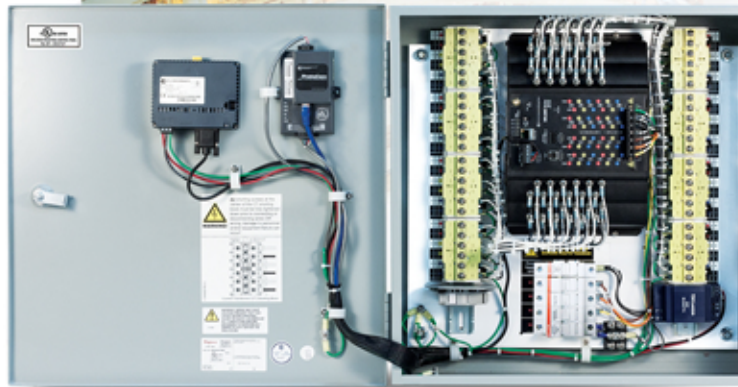

E-SINE
Engineering Solutions

***Installation &
Operation Manual***
V.1.06
May 3, 2018

This page intentionally left blank.

MP200™ in Enclosure Installation and Operation Manual Version 1.06

Published by:

Electro Industries/GaugeTech

1800 Shames Drive

Westbury, NY 11590

Copyright Notice

All rights reserved. No part of this publication may be reproduced or transmitted in any form or by any means, electronic or mechanical, including photocopying, recording, or information storage or retrieval systems or any future forms of duplication, for any purpose other than the purchaser's use, without the expressed written permission of Electro Industries/GaugeTech.

© 2018 Electro Industries/GaugeTech

Shark® is a registered trademark of Electro Industries/GaugeTech. The distinctive shapes, styles and overall appearances of all Shark® meters are trademarks of Electro Industries/GaugeTech. MP200™ is a trademark of Electro Industries/GaugeTech.

LonWorks® is a registered trademark of Echelon Corp.

BACnet® is a registered trademark of ASHRAE.

Modbus® is a registered trademark of Schneider Electric, licensed to the Modus Organization, Inc.

Customer Service and Support

Customer support is available 9:00 am to 4:30 pm, Eastern Standard Time, Monday through Friday. Please have the model, serial number and a detailed problem description available. If the problem concerns a particular reading, please have all meter readings available. When returning any merchandise to EIG, a return materials authorization number is required. For customer or technical assistance, repair or calibration, phone 516-334-0870 or fax 516-338-4741.

Product Warranty

Electro Industries/GaugeTech warrants all products to be free from defects in material and workmanship for a period of four years from the date of shipment. During the warranty period, we will, at our option, either repair or replace any product that proves to be defective.

To exercise this warranty, fax or call our customer-support department. You will receive prompt assistance and return instructions. Send the instrument, transportation prepaid, to EIG at 1800 Shames Drive, Westbury, NY 11590. Repairs will be made and the instrument will be returned.

This warranty does not apply to defects resulting from unauthorized modification, misuse, or use for any reason other than electrical power monitoring. The MP200™ in Enclosure is not a user-serviceable product.

THIS WARRANTY IS IN LIEU OF ALL OTHER WARRANTIES, EXPRESSED OR IMPLIED, INCLUDING ANY IMPLIED WARRANTY OF MERCHANTABILITY OR FITNESS FOR A PARTICULAR PURPOSE. ELECTRO INDUSTRIES/GAUGETECH SHALL NOT BE LIABLE FOR ANY INDIRECT, SPECIAL OR CONSEQUENTIAL DAMAGES ARISING FROM ANY AUTHORIZED OR UNAUTHORIZED USE OF ANY ELECTRO INDUSTRIES/GAUGETECH PRODUCT. LIABILITY SHALL BE LIMITED TO THE ORIGINAL COST OF THE PRODUCT SOLD.

Use of Product for Protection

OUR PRODUCTS ARE NOT TO BE USED FOR PRIMARY OVER-CURRENT PROTECTION. ANY PROTECTION FEATURE IN OUR PRODUCTS IS TO BE USED FOR ALARM OR SECONDARY PROTECTION ONLY.

Statement of Calibration

Our instruments are inspected and tested in accordance with specifications published by Electro Industries/GaugeTech. The accuracy and a calibration of our instruments are traceable to the National Institute of Standards and Technology through equipment that is calibrated at planned intervals by comparison to certified standards. For optimal performance, EIG recommends that any metering device, including those manufactured by EIG, be verified for accuracy on a yearly interval using NIST traceable accuracy standards.

Disclaimer

The information presented in this publication has been carefully checked for reliability; however, no responsibility is assumed for inaccuracies. The information contained in this document is subject to change without notice.

Symbols Used in This Manual



This warning symbol indicates that the operator must refer to an important explanation in the operating instructions. The word following the symbol indicates the type of warning being given.

Ce symbole d'avertissement indique que l'opérateur doit se référer à une explication importante dans les instructions d'utilisation. Le mot suivant le symbole indique le type d'avertissement ne soit donné.

CAUTION!

The instructions given must be followed to prevent damage to equipment.

Les instructions doivent être respectées pour éviter d'endommager l'équipement.

WARNING!

The instructions given must be followed to prevent serious injury to people.

Les instructions doivent être respectées pour d'éviter de graves blessures aux personnes.

About Electro Industries/GaugeTech (EIG)

Founded in 1975 by engineer and inventor Dr. Samuel Kagan, Electro Industries/GaugeTech changed the face of power monitoring forever with its first breakthrough innovation: an affordable, easy-to-use AC power meter.

More than forty years since its founding, Electro Industries/GaugeTech, the leader in power monitoring and control, continues to revolutionize the industry with the highest quality, cutting edge power monitoring and control technology on the market today. An ISO 9001:2015 certified company, EIG sets the industry standard for advanced power quality and reporting, revenue metering and substation data acquisition and control. EIG products can be found on site at mainly all of today's leading manufacturers, industrial giants and utilities.

EIG products are primarily designed, manufactured, tested and calibrated at our facility in Westbury, New York.

Table of Contents

Customer Service and Support	ii
Product Warranty	ii
Use of Product for Protection	iii
Statement of Calibration	iii
Disclaimer	iii
Symbols Used in This Manual	iii
About Electro Industries/GaugeTech (EIG)	iv
1: Introduction	1-1
1.1: Product Handling	1-1
1.2: Safety Precautions	1-2
1.3: Storage	1-3
1.4: Compliance	1-3
2: Installation	2-1
2.1: Installation Step 1 - Unpack the Enclosure	2-2
2.2: Installation Step 2 - Drill the Wiring Holes	2-4
2.2.1: Removing and Reinstalling the Panel	2-7
2.3: Installation Step 3 - Mount the Enclosure	2-9
2.4: Installation Step 4 - Install the Display	2-14
2.5: Installation Step 5 - Lock the Enclosure	2-18
3. Electrical Wiring	3-1
3.1: Wiring Instructions	3-2
4: Operation	4-1

4.1: Overview	4-1
4.2: Troubleshooting	4-1
5. Maintenance	5-1
A. Removing a Meter from Service	A-1
A.1: Removing the Meter	A-1
A.2: Reinstalling the Meter	A-6

1: Introduction

The MP200™ in Enclosure lets you expand your switchgear capability and/or easily meter circuits without expensive and time-consuming redesign. Simply mount the enclosure in any convenient location, next to your switchgear or on a wall, and you are ready to go, with no downtime.

This is an ideal solution for a retrofit when there is no metering compartment available. The unit comes standard with a NEMA 1 rated enclosure and is factory wired with the metering system installed. Standard safety equipment includes voltage fuses and shorting blocks for current transformers.

The enclosure can be ordered with either the MP200-Y three phase circuit configuration or the MP200-S single phase circuit configuration, and comes standard with either a 3"x5" or 5"x7" touch-screen display. BACnet® or LonWorks® protocol is available as an add-on to the existing standard Modbus® capability. See Chapter 6 for ordering instructions.

1.1: Product Handling



CAUTION! READ AND UNDERSTAND THE INSTRUCTIONS CONTAINED IN THIS DOCUMENT BEFORE ATTEMPTING TO UNPACK, INSTALL, OPERATE, OR MAINTAIN THIS EQUIPMENT.

Every effort is made to insure that the equipment arrives undamaged and ready to be installed. Packing is designed to protect internal components as well as the enclosure. Do not remove protective packing until you are ready to install the equipment.

When you receive the equipment, you should inspect the shipping container for any obvious signs of rough handling and/or external damage that occurred during transportation. Record any external and internal damage for reporting to the transportation carrier and EIG. All claims should be as specific as possible and include general order numbers.

You will find a plastic bag of instruction booklets and/or CDs in the shipping container. Store these documents in a safe place.

1.2: Safety Precautions



WARNING! All safety codes, safety standards, and/or regulations must be strictly observed in the installation, operation, and maintenance of this device.

Hazardous voltages that can cause death or severe personal injury are present inside enclosure. Follow proper installation, operation, and maintenance procedures to avoid these voltages.

Avertissement! tous les codes de sécurité, normes de sécurité et règlements doivent être suivis strictement dans l'installation, le fonctionnement et la maintenance de cet appareil.

Des tensions dangereuses peuvent provoquer la mort ou des blessures graves. suivre l'installation adéquate, le fonctionnement et les procédures de maintenance pour éviter ces tensions.

Completely read and understand the material presented in this document before attempting installation, operation, or application of the equipment. In addition, only qualified persons should be permitted to perform any work associated with the equipment. Any wiring instructions presented in this document must be followed precisely. Failure to do so could cause permanent equipment damage.

All possible contingencies that may arise during installation, operation, or maintenance, and all details and variations of this equipment do not purport to be covered by these instructions. If further information is desired by purchaser regarding a particular installation, operation, or maintenance of particular equipment, contact an Electro Industries/GaugeTech (EIG) representative.

1.3: Storage

Although it has been well packaged, this equipment should not be stored outdoors. If the equipment is to be stored indoors for any period of time, it should be stored with its protective packaging in place. Refer to the *MP200™ Metering System Installation and Operation* manual, on the enclosed CD, for the meter's storage requirements.

The temperature rating for enclosure storage is (-20 to +60) °C/(-4 to +140) °F.

1.4: Compliance

UL / cUL Listed, UL508A, File number: E358101.

This page intentionally left blank.

2: Installation



WARNING! All safety codes, safety standards, and/or regulations shall be strictly observed in the installation, operation, and maintenance of this device. **This device shall be installed in an un-energized condition and as per the National Electric Code.**

AVERTISSEMENT! Tous les codes de sécurité, normes de sécurité et règlement doivent être suivis strictement pour l'installation, le fonctionnement et la maintenance de cet appareil. **Cet appareil doit être installé hors tension conformément au code électrique national (National Electric Code).**

Choose a mounting location that offers a flat, rigid mounting surface capable of supporting the weight of the equipment. The unit weighs 48.5 lbs (22 kg) maximum. Mount the equipment in a suitable environment. This enclosure is designed for NEMA 1 rated environments and is manufactured of painted steel.

Check to make certain that there are no pipes, wires, or other mounting hazards in the immediate mounting area that could create a problem. Also make sure you have enough clearance around the enclosure to run wiring to it safely. EIG recommends at least 2 feet of clearance around the enclosure. See Section 2.1 for enclosure dimensions.

Carefully remove all packing material from the unit. Even though an equipment inspection was made when the equipment was received, make another careful inspection of the enclosure and the devices inside as packing material is removed. Be especially alert for distorted metal, loose wires, or damaged components. This is important because wiring can come loose in shipping and could cause a short circuit or voltage to be on the wrong terminal.



WARNING! Extreme care shall be taken when mounting the enclosure, and making wire entry holes, to prevent metal chips, filings, and other contaminants from entering the enclosure which may damage the equipment and create a hazardous condition.

AVERTISSEMENT! Attention extrême lors de la monture de l'enceinte et lors de la mise à terre pour prévenir les articles métalliques, remplissage et autre contaminant de l'entrée de l'enceinte qui peuvent provoquer une condition dangereuse de l'équipement.

2.1: Installation Step 1 - Unpack the MP200™ in Enclosure

The MP200™ in enclosure ships in two parts:

- The meter enclosure
- The mountable color display

The display is shipped separately in order to protect it from being damaged during shipping.

Instructions for the enclosure begin on the next page. Section 2.4 contains instructions for mounting the display.

The enclosure components are shown in the image below:

- A: MP200 current inputs (24 of them)
- B: CT shorting blocks (8 of them)
- C: CT connections
- D: Voltage inputs and 5 fuses
- E: Earth ground on inside of enclosure
- F: Ground wire on enclosure door
- G: Cable assembly
- H: Display connectors
- I: Hole for mounting the display
- J: If ordered, optional Add-on Protocol - ProtoCom/ProtoCom-Lon

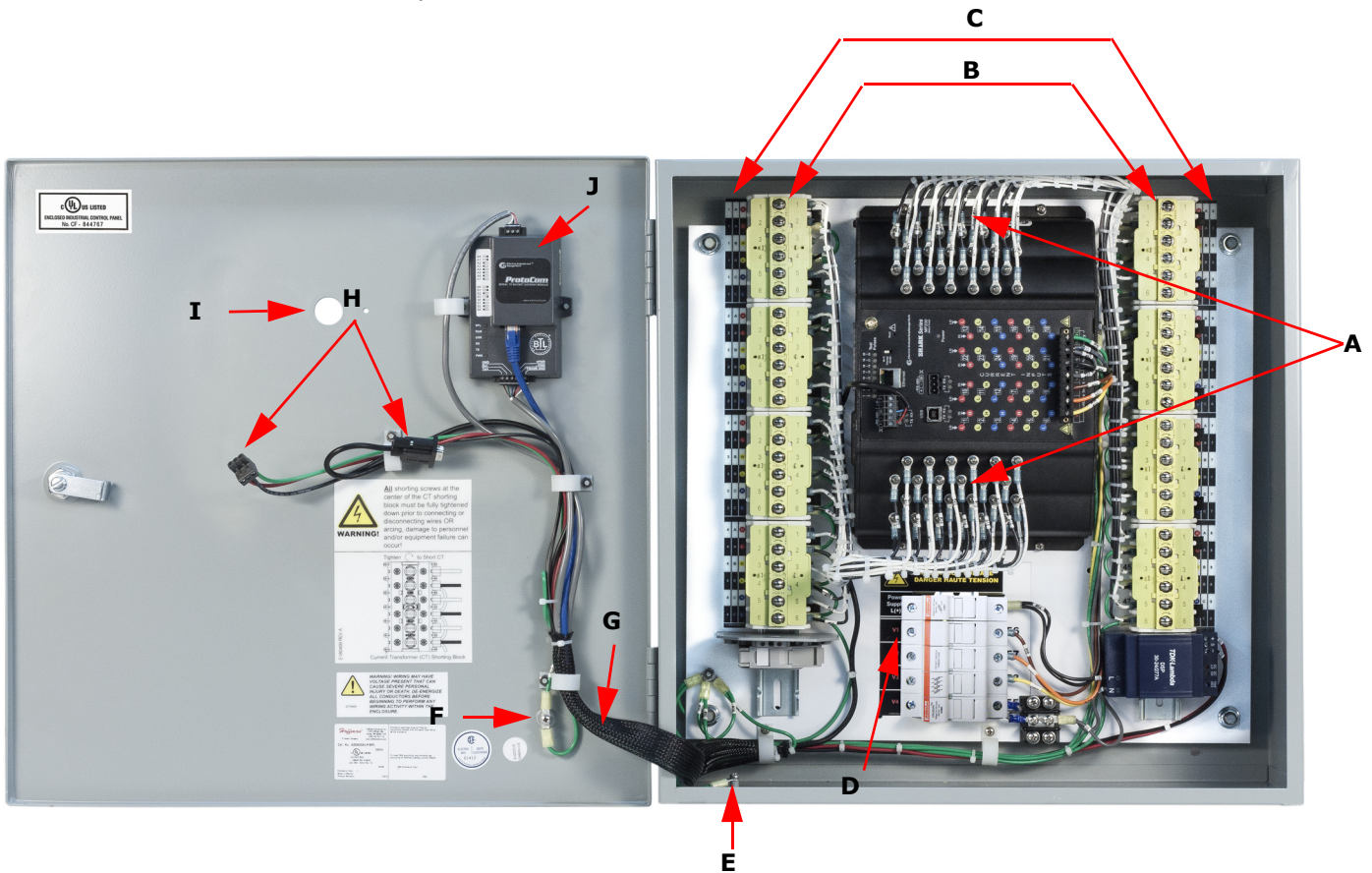

Figure 2.1: MP200™ in Enclosure as Shipped

2.2: Installation Step 2 - Drill the Wiring Holes

Cut the holes you need in the bottom of the enclosure for the power, CT, and communications wiring. See the figure below for the allowable location.

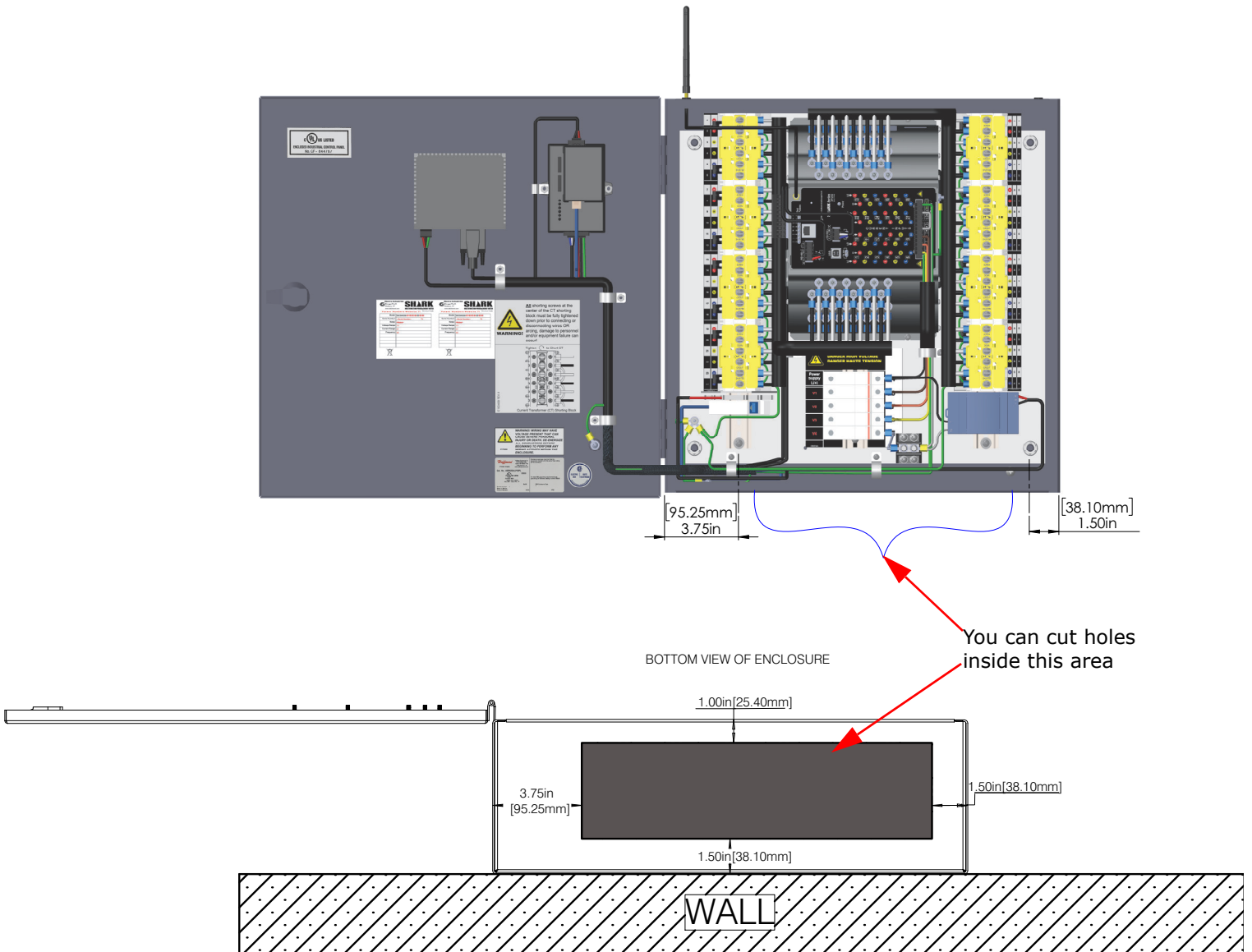

Figure 2.2: Location for Punch Entries

The drawings show the area in the bottom of the enclosure where wiring holes can be cut: 1" [25.40mm] from the front of the enclosure, 1.5" [38.10mm] from the right side of the enclosure, 1.5" [38.10mm] from the back of the enclosure, and 3.75" [95.25mm] from the left side of the enclosure.

**CAUTIONS!**

- There are numerous methods for making wire entry holes in the enclosure but it is imperative that no loose material generated during the process remains in the enclosure. During installation and cutting the wire holes, all equipment mounted inside or on the enclosure shall be protected from loose material.
- No matter what procedure is used the installer shall verify that the hole cutting process will not damage any of the wiring or components installed inside or on the enclosure.
 - a. The two recommended procedures for cutting the wire entry holes are as follows:
 - Use a "C" frame punch to cut the wire entry holes. This type of punch does not require a pilot hole. A typical "C" frame punch is shown below.



Figure 2.3: "C" Frame Punch

- Regular punch:
 1. Place a magnet inside the enclosure where the pilot hole is to be cut and completely cover the area with masking tape (or other very sticky tape).
 2. Drill the pilot hole from the outside and do not let the drill pass more than ¼" into the enclosure.
 3. Remove the tape, magnet, and cuttings and punch the hole.

- b. After wiring and before energizing, vacuum the inside of the enclosure to make sure that it is free of foreign material. If a vacuum is not available use an alternate method to clean the inside of the enclosure. Do not use compressed air (or pressurized gas) to clean the inside of the enclosure as this may force cuttings into areas that cannot be seen, creating a hazardous condition.



IMPORTANT! All wire entry into the enclosure shall be accomplished with the use of recognized fittings or strain reliefs. Bare holes shall not be used.

NOTE: The panel can be removed to facilitate drilling of wiring holes. See the following procedure.

2.2.1: Removing and Reinstalling the Panel

If it will make it easier to drill the wiring holes, you may remove the panel.

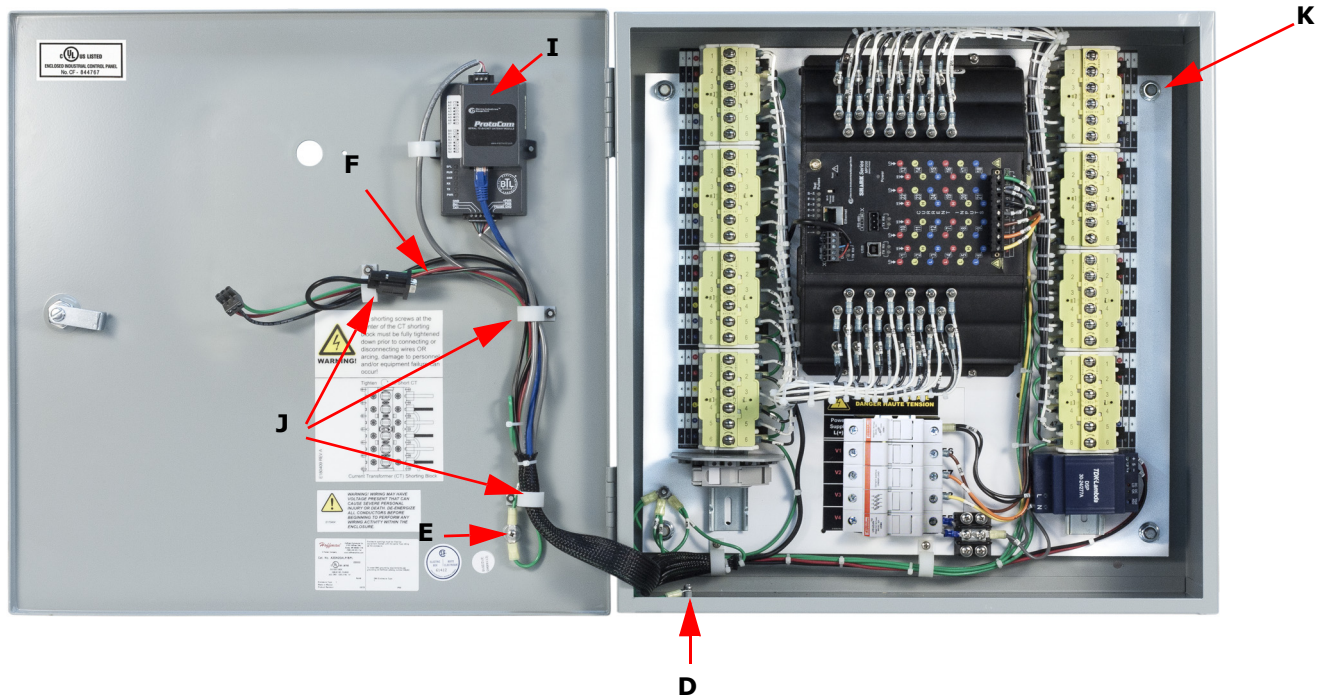

Figure 2.4: Removing the Panel

1. If the MP200™ in enclosure is equipped with a ProtoCom/ProtoCom-Lon add-on protocol unit remove all connections from the ProtoCom/ProtoCom-Lon (I).
2. Disconnect the green ground wires from the door (E).
3. Open the cable clamps on the door (J) and remove the cable assembly (F).
4. Remove the green ground wires on the lower left side of the enclosure (D).
5. Remove the four nuts, one in each corner of the panel [K].
6. Carefully remove the panel from the enclosure.

Drill the wiring holes per the instructions in Section 2.2. You can then re-install the panel.

1. Place the panel on the four mounting studs in the enclosure and install and tighten a nut on each of the studs (K).

2. Connect the green ground wires to the ground stud on the bottom left of the enclosure (D).
3. Insert the cable assembly (F) into the cable clamps on the door (J).
4. Connect the two green ground wires to the stud on the door (E).
5. If the MP200™ in enclosure is equipped with a ProtoCom/ProtoCom-Lon, attach all connections to it (I).

Continue to Section 2.3 to mount the enclosure.

2.3: Installation Step 3 - Mount the Enclosure

1. Determine the enclosure mounting location - where there are no obstacles and the exterior wiring can be easily accomplished. Install as per the NEC or local code requirements. Refer to the following diagrams for the enclosure dimensions.

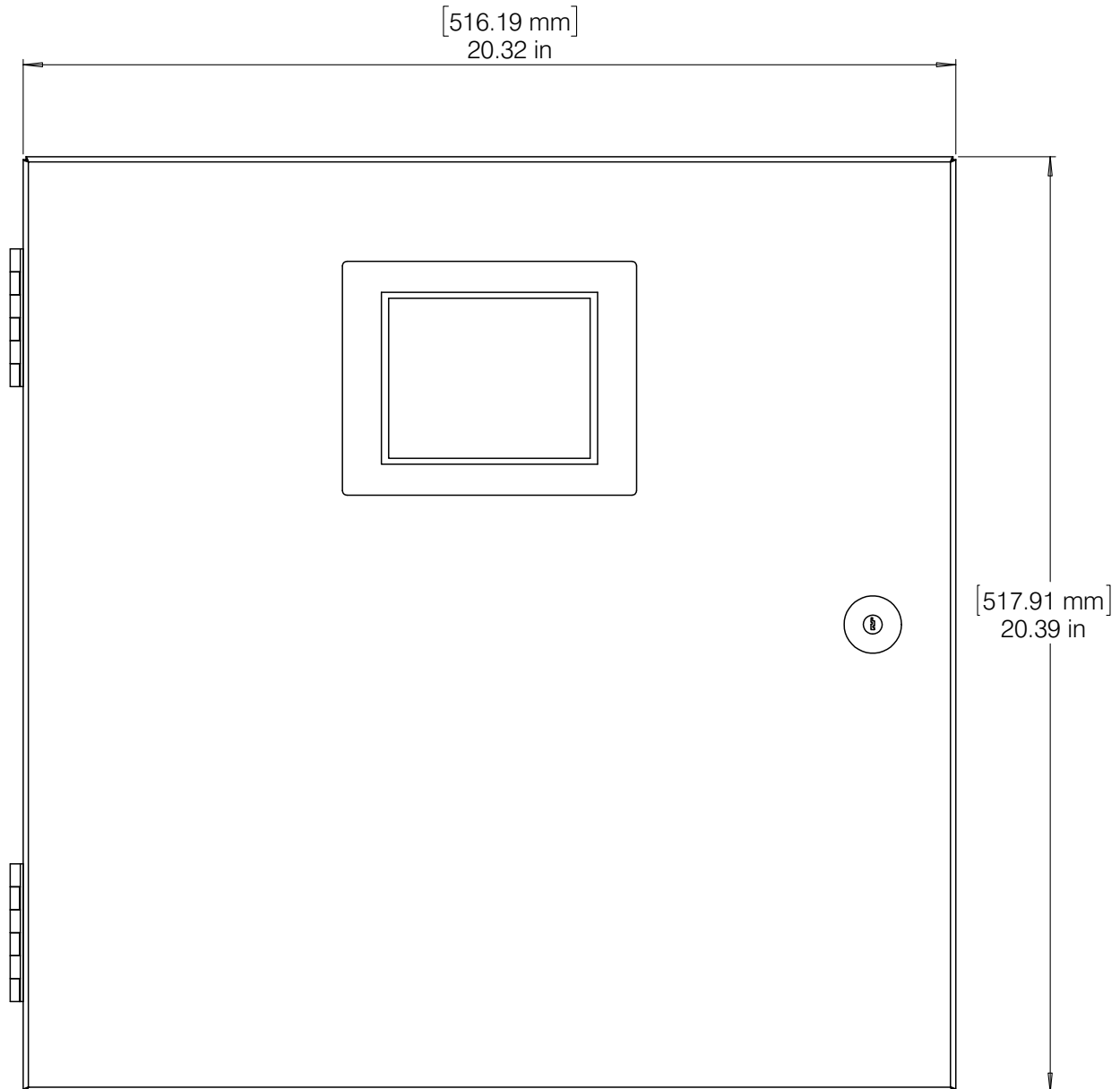

Figure 2.5: Enclosure Front Dimensions

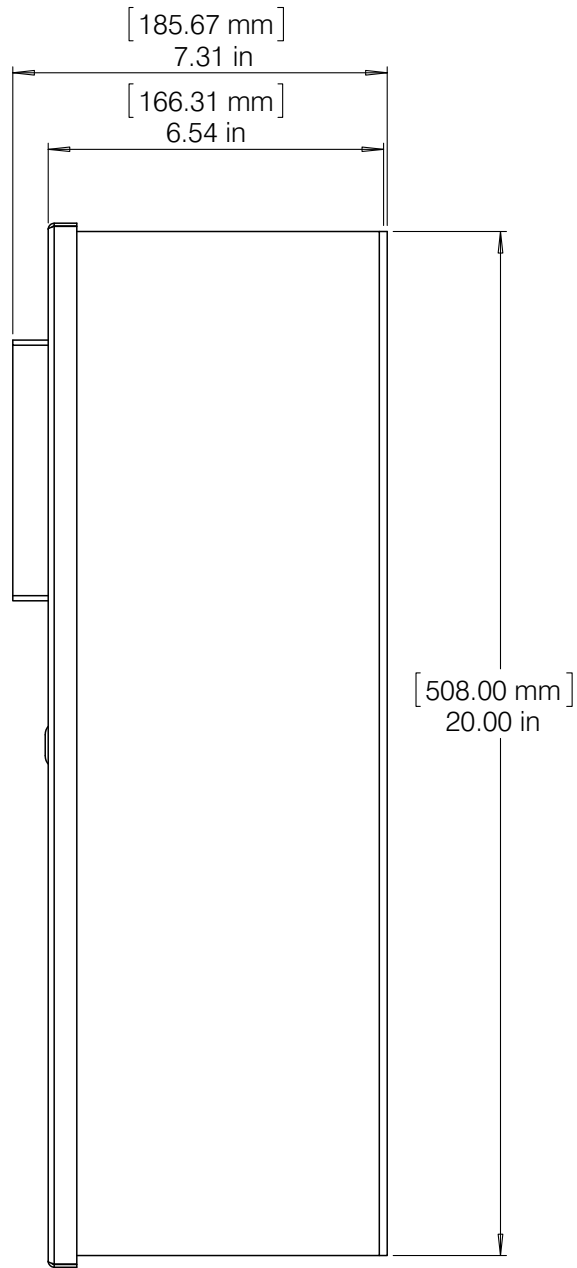

Figure 2.6: Enclosure Side Dimensions

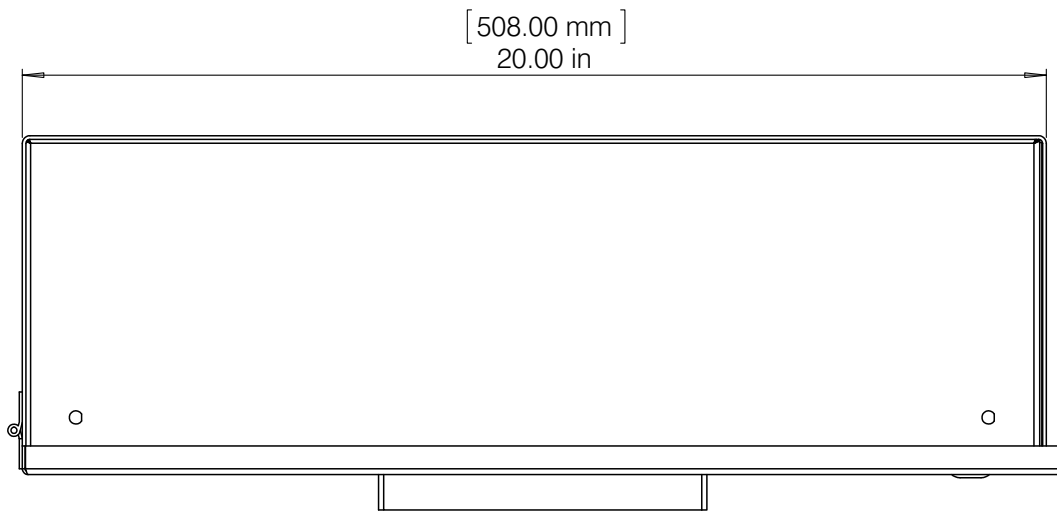

Figure 2.7: Enclosure Top Dimensions

2. Mark the location of the four mounting points on the surface where the enclosure will reside.

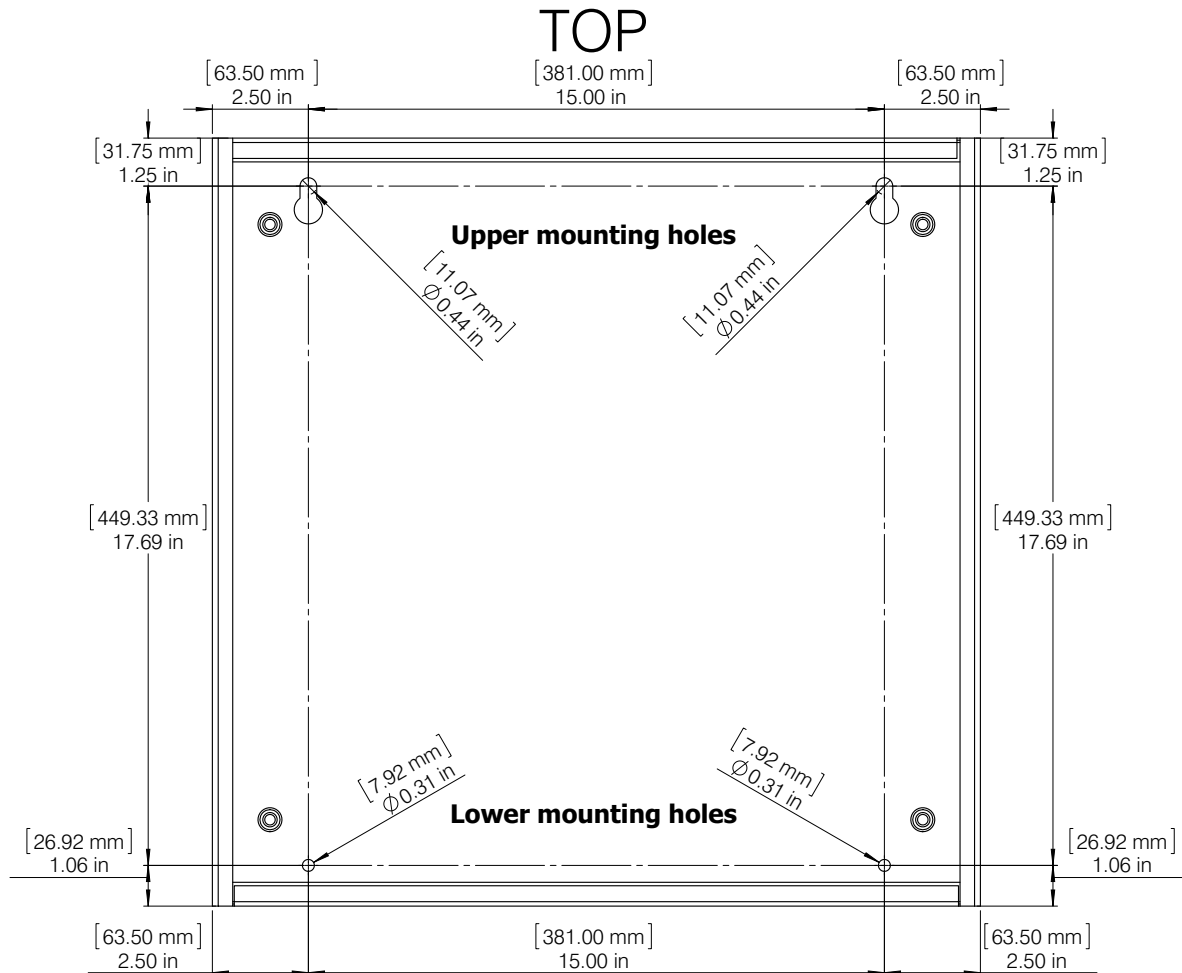

Figure 2.8: Mounting Hole Locations and Dimensions

3. Prepare the mounting points using attachment means appropriate for the surface supporting the enclosure.
4. Put two fasteners (screws or bolts) in the top two mounting locations, the fasteners shall have a head diameter of no greater than 0.65" and a maximum body diameter of 0.25".
5. Install upper mounting screws; leave a 3/8" gap between the screw head and the mounting surface.
6. Lift the enclosure and hang it from the top two bolts.

7. Install lower mounting screws from the inside of the cabinet. Loosely tighten.
- 8.If necessary shim between the mounting surface and the enclosure to compensate for any irregularities.
- 9.Tighten the lower two fasteners.

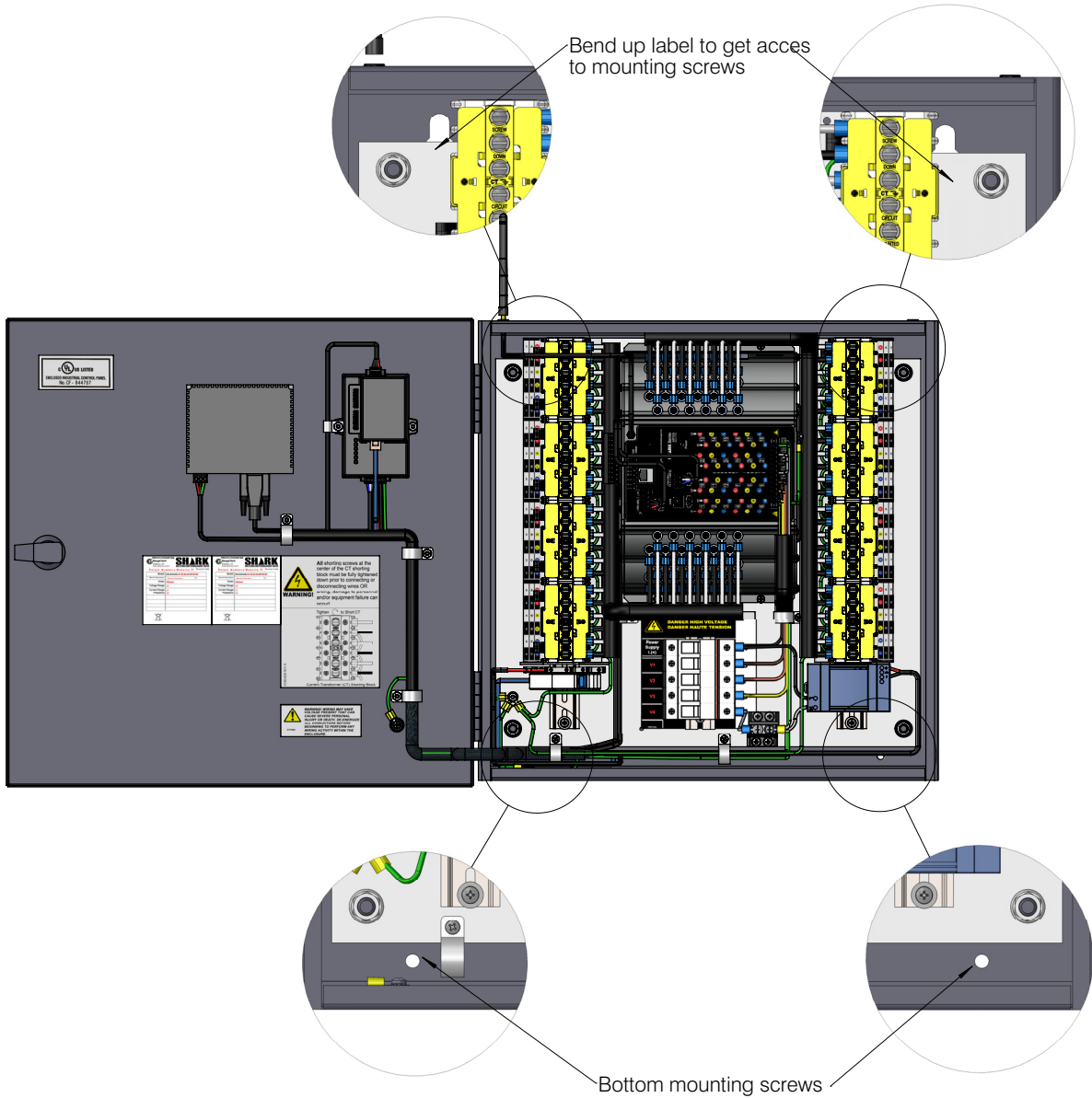

Figure 2.9: Location of Mounting Screws

10. Fold back the CT wiring labels in the upper right and left corners of the enclosure (see figure above) and tighten the upper two mounting fasteners.

2.4: Installation Step 4 - Install the Display

The display ships separately from the enclosure. The contents of the display box are shown below.

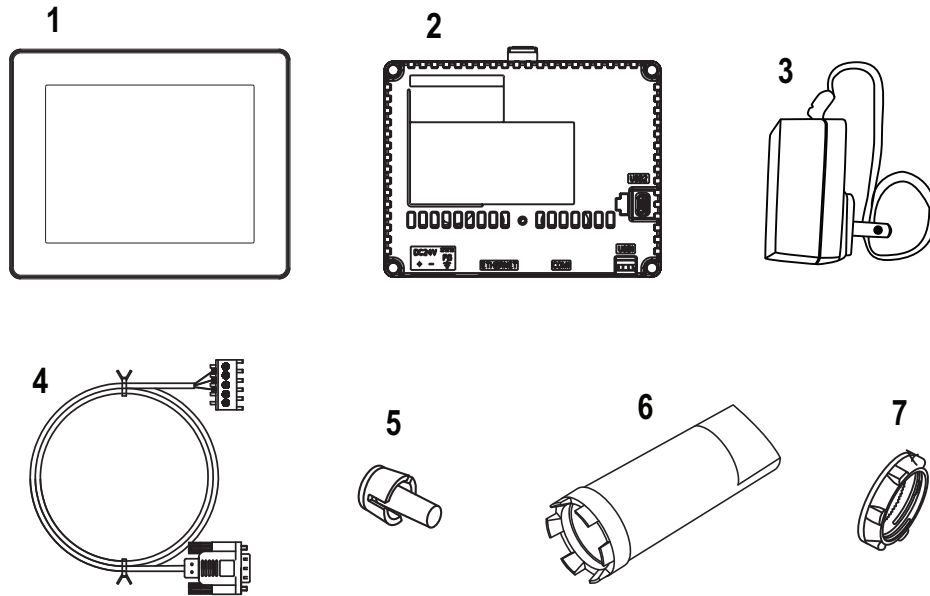

Figure 10.10: Display Kit Contents

- (1) Display
- (2) Rear Module
- (3) Power Supply*
- (4) RS485 Serial Cable (10 feet)*

Mounting Hardware:

- (5) anti-rotation tee
- (6) socket wrench
- (7) installation nut, attached to the back of the display

*These items are included in the display box, but are only needed if you want to mount the display remotely, rather than in the enclosure. If you are mounting remotely, cover up the display mounting hole that is in the enclosure cover.

Follow the instructions beginning on the next page to mount the display in the enclosure front cover.

1. There are 5 parts to the display as installed in the MP200™ in enclosure:

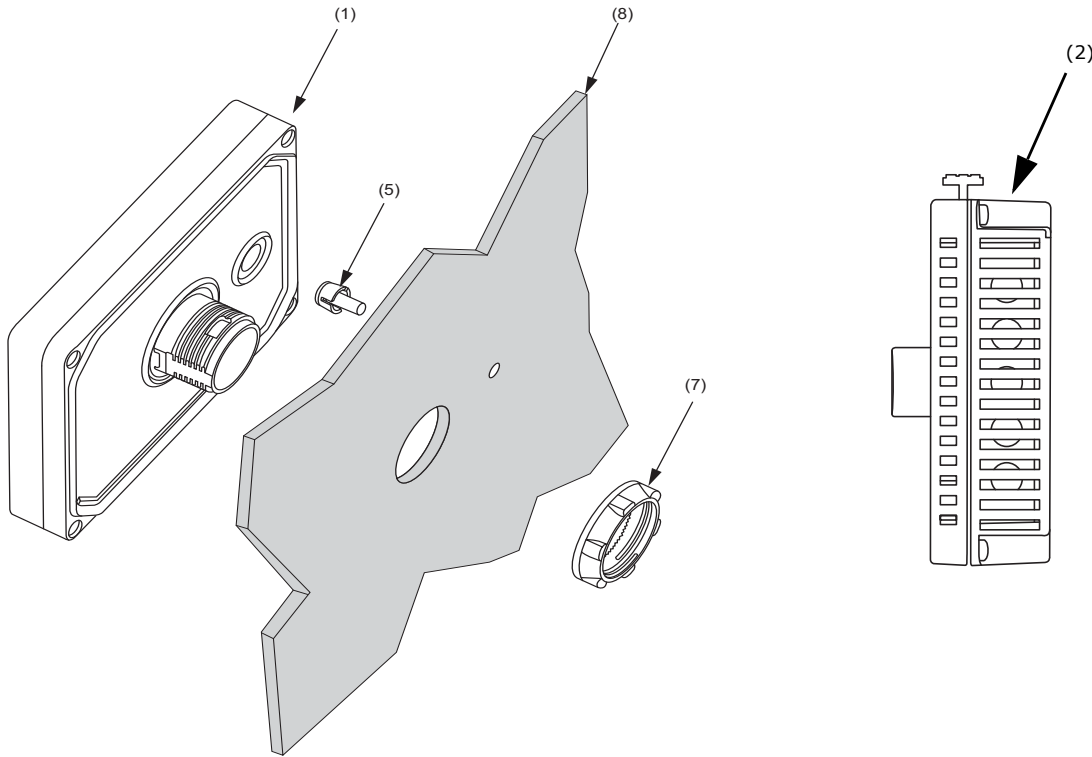

Figure 2.11: Display Components for Mounting in Enclosure

- Display module and touch screen (1)
- Panel with cutout (8)
- Display installation nut (7)
- Anti-rotation Tee (5)
- Rear module, containing the electronics to run the display (2)

2. Press the Anti-rotation tee (5) into the display module (1), in the hole provided [9].

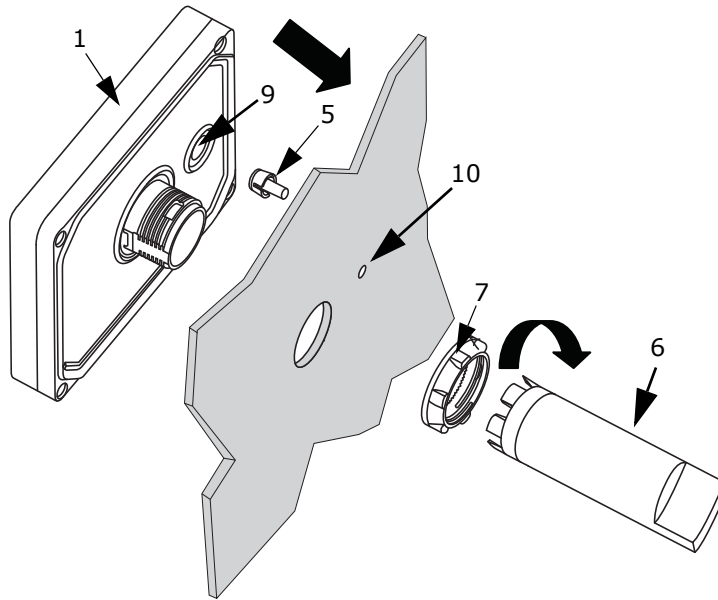

Figure 2.12: Inserting the Display into the Panel

3. Insert the display module, with the anti-rotation Tee attached, into the cutout, aligning the anti-rotation tee so that it passes through the small hole in the panel (10).
4. Place the display installation nut on the portion of the display passing through the panel and “finger tighten” it.
5. Using the socket wrench supplied [6], tighten the display installation nut (7) with a torque between 1.2 and 1 Nm (10.6 to 17.7 in-lb).

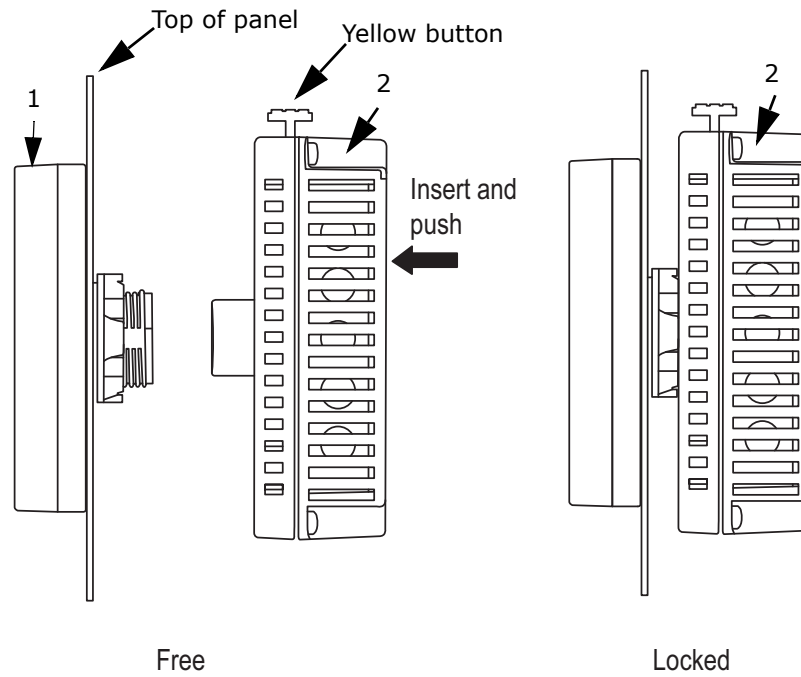

Figure 2.13: Connecting the Rear Module to the Display Module

6. Carefully insert the rear module (2), with the yellow button to the top of the enclosure, and push the rear module until it locks into place. When it is in place you will hear a "click."
7. Connect the cable to the rear module: see Figure 2-1.

2.5: Installation Step 5 - Lock the Enclosure

The enclosure has been fitted with means for securing the door so it cannot be opened or tampered with. A key lock is provided along with two keys.

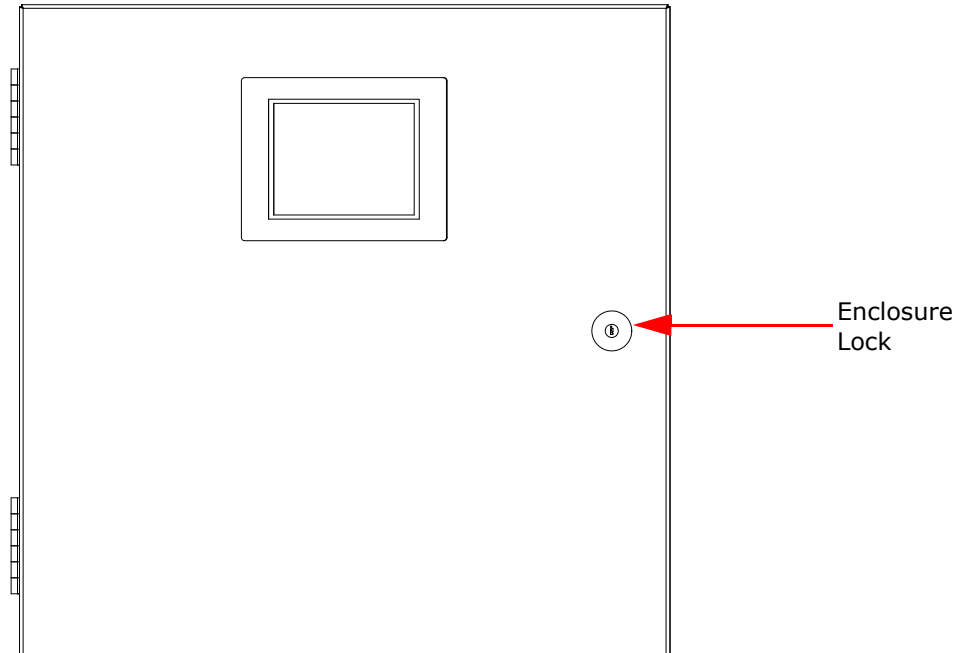

Figure 2.14: Location of Enclosure Lock

1. Lock the enclosure by putting the key in the lock and turning it clockwise.
2. Remove the key and store it in a safe place. When you want to open the enclosure, put the key in the lock and turn it counter-clockwise. Repeat step 1 to re-lock the enclosure.

3. Electrical Wiring

The MP200™ in Enclosure is factory wired and tested. Installation requires solidly mounting the enclosed unit and connecting field wiring. This document has diagrams of wiring options. Review and understand the appropriate diagrams for the unit you have ordered.

NOTE: See the diagram below for input wiring specifications. Consult your local and/or National Electric Code for external wiring requirements.

IMPORTANT! ALL CONNECTIONS TO THIS PRODUCT ARE TO BE WITH COPPER WIRE ONLY! TOUS LES CONNEXIONS À CE PRODUIT DOIVENT FAIRE UN FIL DE CUIVRE SEULEMENT!

Both enclosure models are pre-wired and programmed for either three phase or single phase operation.

NOTE: The current inputs are only to be connected to external current transformers provided by the installer. The CT's shall be Listed to ANSI/IEEE C57.13 and rated for the current of the meter used.

A DISCONNECTING MEANS AND UPSTREAM PROTECTION SHOULD BE INSTALLED FOR ALL CIRCUITS. A SHORT-CIRCUITING-TYPE TERMINAL BLOCK IS PROVIDED FOR THE CURRENT TRANSFORMER CIRCUIT.

INPUT WIRING SPECIFICATIONS			
Location	Wire Size	Screw Size	Maximum Torque
Shorting Block	#6-22 AWG CU	#10-32	20 lbf-in (2.3 N-m)
Fuse Block L(+), V1-V3	#10-18 AWG CU	#10-32	20 lbf-in (2.3 N-m)
Fuse Block V4	#10-12 max CU	#10-32	20 lbf-in (2.3 N-m)
Earth Ground	#10-12 AWG CU	#8-32	10 lbf-in (1.2 N-m)

3.1: Wiring Instructions

**WARNING!**

First connect Earth Ground as shown in the figure below.

AVERTISSEMENT! Branchez d'abord la mise à la terre comme indiqué dans le dessin ci-dessous.

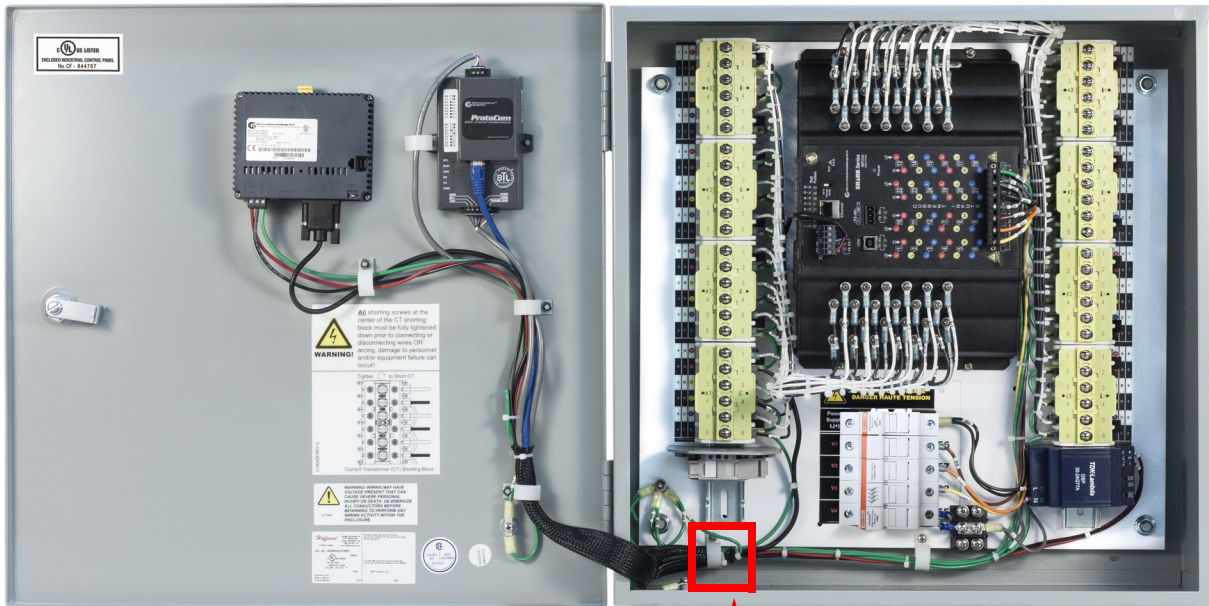

Earth Ground

Figure 3.1: Earth Ground Connection

Understand the diagram(s) that pertain to your unit before you begin the field wiring. The following figures show the available wiring options. Understand your system and use the appropriate figures.



WARNING! CONTROL WIRING MAY HAVE VOLTAGE PRESENT THAT CAN CAUSE SEVERE PERSONAL INJURY OR DEATH. DE-ENERGIZE ALL CONDUCTORS BEFORE BEGINNING TO PERFORM ANY WIRING ACTIVITY TO OR WITHIN THE MP200™ IN ENCLOSURE.

AVERTISSEMENT! LE CÂBLAGE DES COMMANDES PEUT AVOIR UNE TENSION PRÉSENTE QUI PEUT PROVOQUER DES BLESSURES GRAVES POU LA MORT. METTRE HORS TENSION TOUS LES CONDUCTEURS AVANT DE COMMENCER LA RÉALISATION D'UNE ACTIVITÉ DE CÂBLAGE DANS L'ENCEINTE DE L'ASSEMBLAGE MP200™.

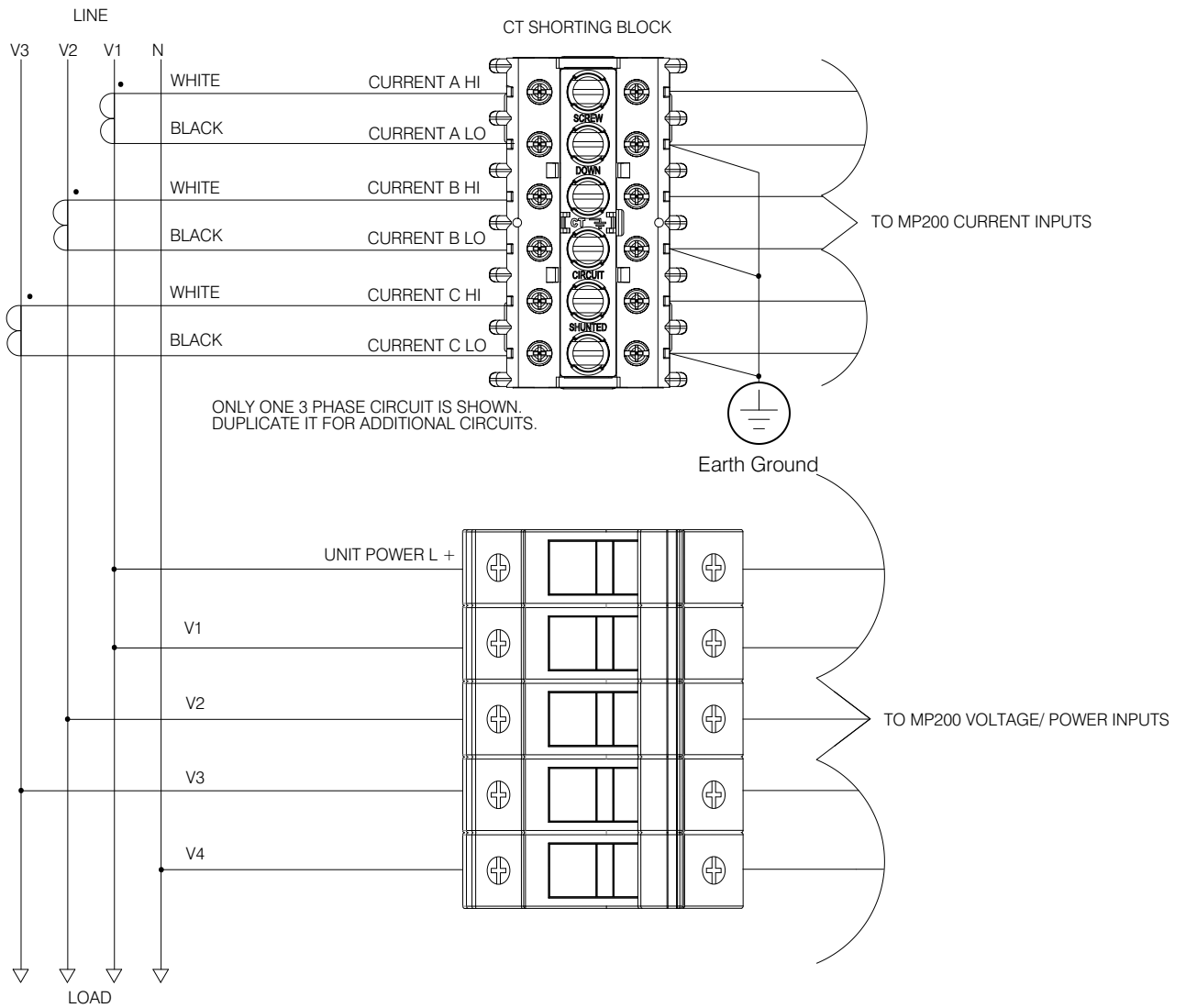

Figure 3.2: MP200-Y Three Phase Wiring Diagram

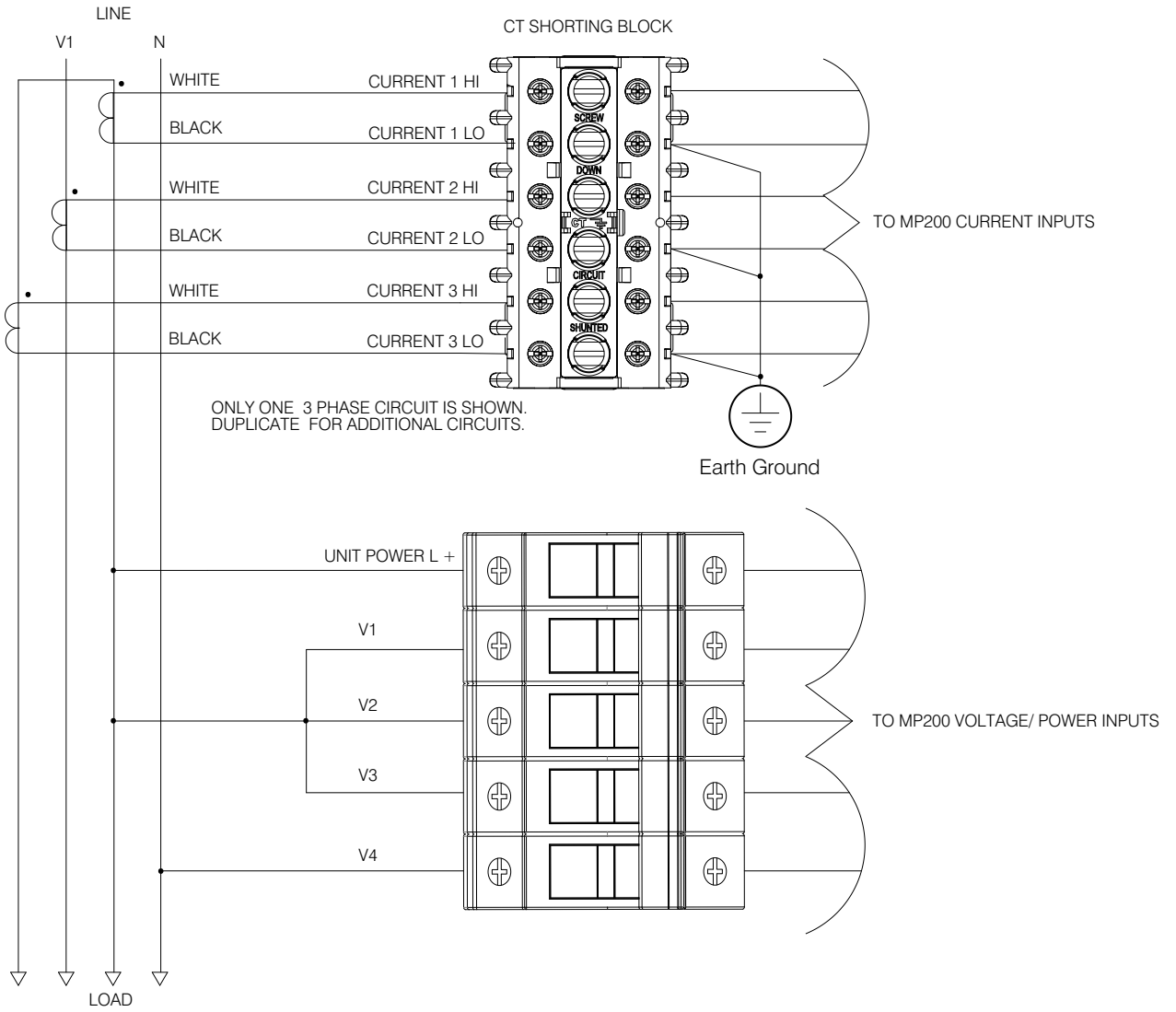

Figure 3.3: MP200-S Single Phase 2 Wire Wiring Diagram

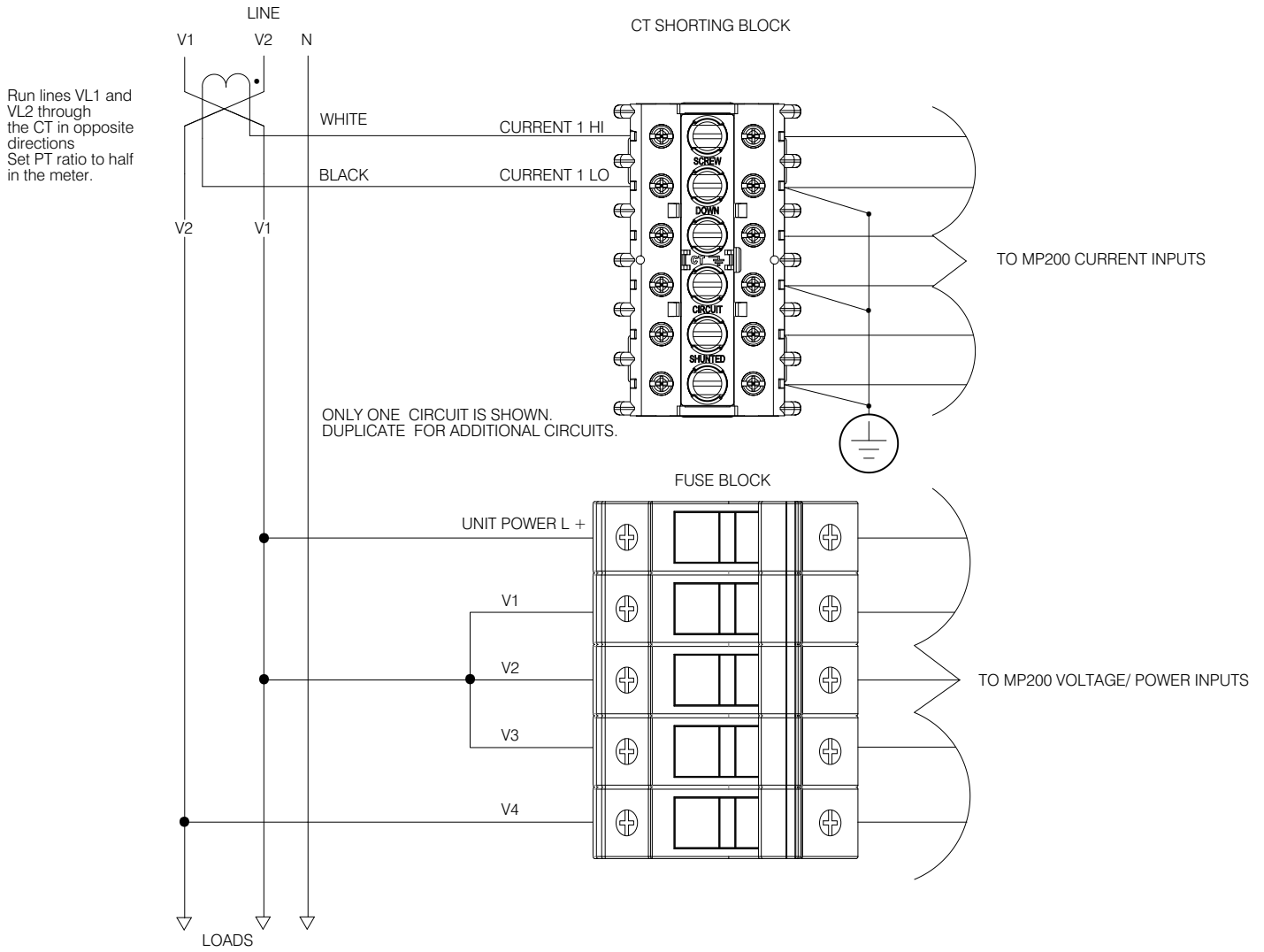

Figure 3.4: MP200-S Single-Phase 3 Wire Wiring Diagram

4: Operation

4.1: Overview

The MP200™ in Enclosure is equipped with three 10mm x 38mm, 600V, 100mA, fast-acting fuses and two 10mm x 38mm, 500V, 3A, Time Delay fuse for the protection of the meter's sense voltage and control power circuits, respectively.

A disconnecting means and upstream protection should be installed for all circuits. Short-circuiting type terminal blocks are provided for the current transformer circuit and are equipped with captive shorting screws (see instructions in Section 5.1).

The temperature rating for enclosure operation is (0 to +50) °C/(32 to 122) °F.

Refer to the *MP200™ Metering System Installation and Operation Manual* for specific operating instructions for the system in your enclosure.

4.2: Troubleshooting

Symptom: Extremely inaccurate readings of voltage and/or harmonics.

Perform these two tests:

1. With fuses removed from the unit, test the fuses with an ohmmeter. All of the fuses must show a resistance of <2 Ohms.
2. With the unit fully powered, measure the voltage on the input side and output side of the fuse. The voltages should differ by less than 1 Volt.

This page intentionally left blank.

5. Maintenance

The MP200™ in Enclosure is designed to be relatively maintenance-free under normal use. However, because of the variability of application conditions and the importance placed on dependable operation and inspection, you should perform maintenance checks on a regularly scheduled basis. Visually inspect for loose parts, wires, and/or hardware; inspect for discoloration of insulation and damaged or discolored components; be alert for accumulation of dirt and/or moisture on structure; check operation of disconnecting means and continuity of fuses, where applicable.

If you ever need to remove the meter from service, refer to Appendix A. Removing a Meter from Service, on page A-1.

This page intentionally left blank.

6. Ordering Information

ENCMP200 - **Y** - **60** - **10** - **V2** - **485P** - **MDSN** - **ProtoCom**
 1 2 3 4 5 6 7 8

1. Model:

ENCMP200 - MP200™ Metering System in NEMA 1 Enclosure

2. Circuit Configuration

Y - Three Phase WYE

S - Single Phase Only

3. Frequency

50 - 50Hz

60 - 60Hz

4. Current Class

10 - 10 Amp Secondary

2 - 2 Amp Secondary

5. V-Switch™ Key Pack

V1 - Transducer

V2 - Basic Logger

V3 - Advanced Logger

6. Communication

X - RS485 Only (Modbus)

WIFI - Ethernet and WiFi (Modbus)

7. Display

MDSN - 3.5" Touch Screen HMI Display with installation kit

MDLN - 5.7" Touch Screen HMI Display with installation kit

(Display Installation Kit includes: Display and Rear Module, RS485 Serial cable, Power Supply, Mounting Hardware)

8. Add-on Protocol

X - No Add-on Protocol

ProtoCom - BACnet Protocol

ProtoCom-Lon - LonWorks Protocol

Example above:

ENC SMP200-Y-60-10-V2-X-MDSN-ProtoCom

(MP200-Y Metering System, with 60Hz frequency, Current Class 10, V-2 V-Switch™ key, RS485 only, MDSN 3.5" Touch Screen HMI Display, and ProtoCom converter)

A. Removing a Meter from Service

This appendix contains instructions to follow if you ever need to remove the meter from service.

A.1: Removing the Meter

Follow these steps:

1. De-energize all circuits feeding the case.
2. If possible de-energize lines that the CTs are on.
3. Tighten all the shorting screws on all the CT shorting blocks by turning all the screws clockwise until they bottom out.



WARNING! If the meter must be removed from service, the secondary side of the current transformers **MUST** be short circuited to prevent a dangerous high voltage condition from appearing across the secondary wires of the current transformer. **Arcing and damage to personnel and/or equipment can occur if the screws provided on the shorting block are not installed in the correct locations, prior to disconnecting any wires.**

AVERTISSEMENT! Si le compteur doit être enlevé du service, le côté secondaire du transformateur actuel DOIT être court-circuité pour prévenir une condition de haute tension dangereuse d'apparaître dans les câblages secondaires du transformateur actuel. La brûlure d'arc et l'endommagement d'un équipement ou des blessures sont susceptibles de se produire si les vis fournies sur le court-circuit ne sont pas installées dans les emplacements corrects avant de débrancher les câbles.

The six screws on each shorting block are used to short the high (+) sides and the low (-) side of the CT outputs to the brass bar that is internal to the shorting block. The pre-installed jumper connects all lows together and to ground.



WARNING! The screws need to be screwed down until the screw makes contact with the internal bar, enabling the bar to become electrically common with the terminal strip, and grounded.

Les vis doivent être vissées jusqu'à ce que la vis soit en contact avec la barre interne, permettant à la barre de devenir électriquement commune à la barrette de raccordement et mise à la terre.

The figure below shows where the screws are located that must be tightened down to short the CTs.

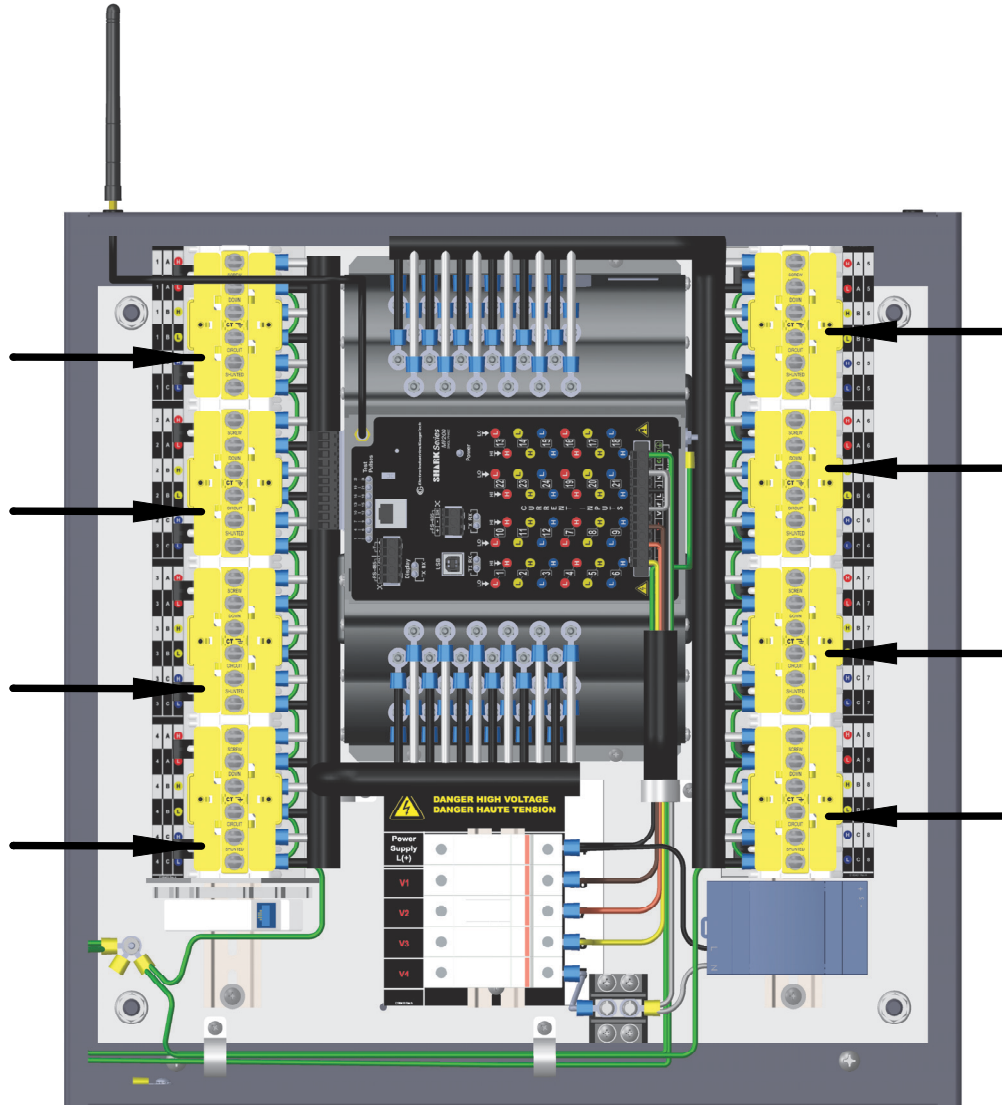
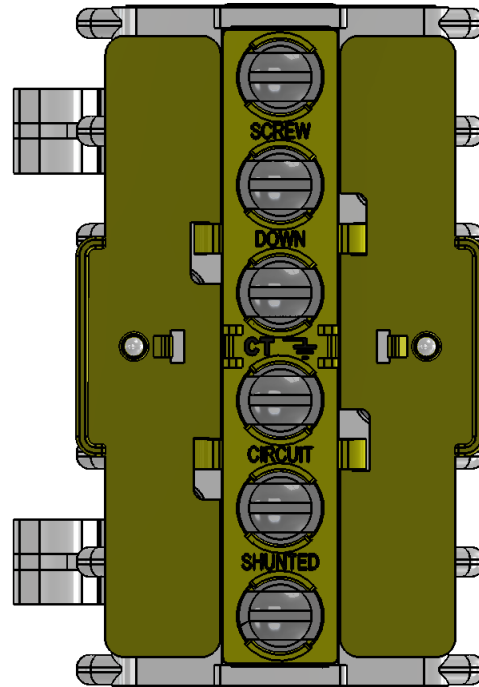

Figure A.1: CT/Shorting Block Location



TURN SCREWS CLOCKWISE 
TO SHORT THE CT

A.2: Shorting the CT



WARNING! When you re-install the meter, make sure all CT connections are made **BEFORE** unscrewing the shorting screws. See A.2: Reinstalling the Meter, on page A-6

AVERTISSEMENT! Lorsque vous réinstallez le compteur, assurez-vous que toutes les connexions de TC (transformateur de courant) sont faites **AVANT** de dévisser les vis de court-circuit. Voir la section A.2.

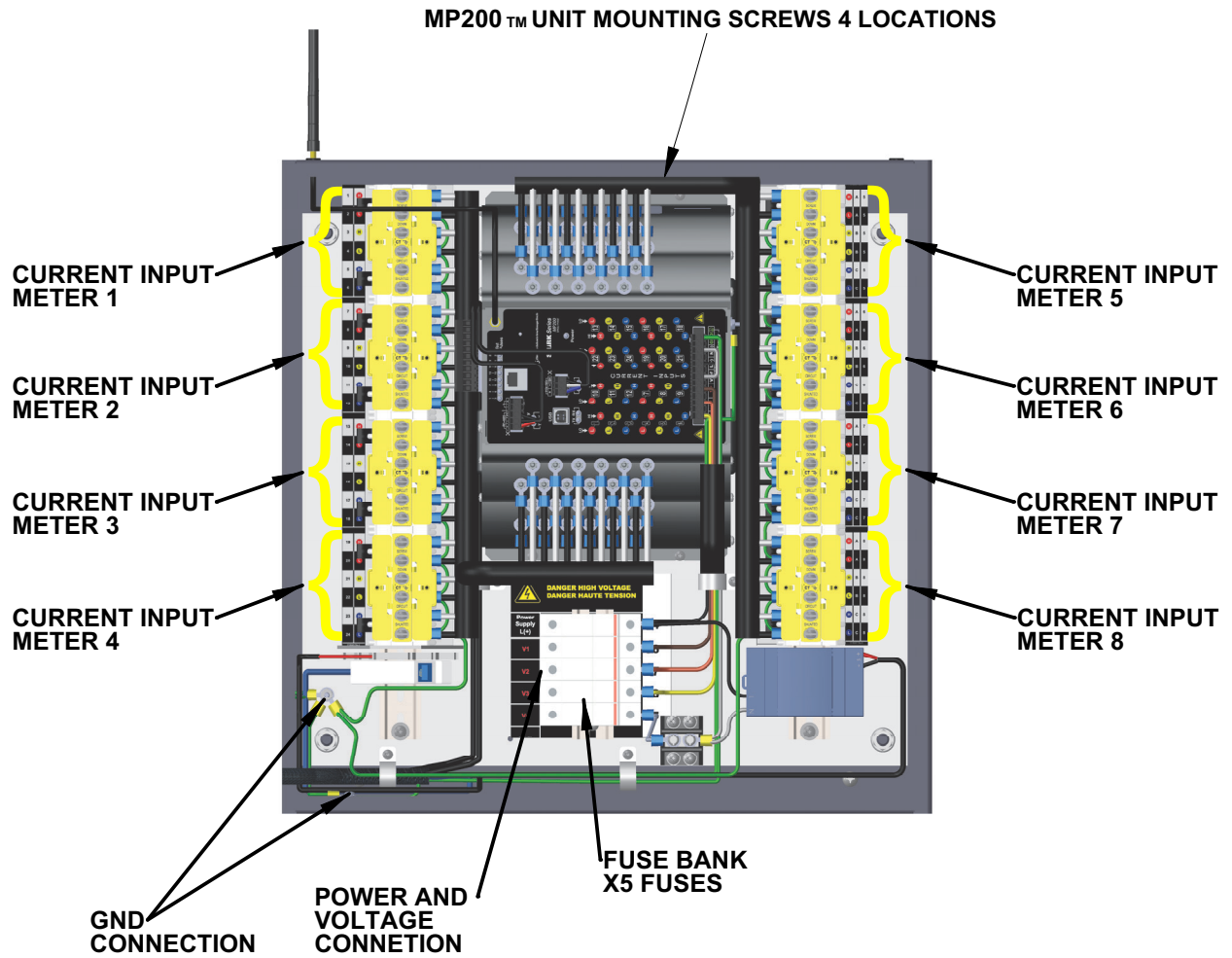

Figure A.3: MP200-Y in Enclosure Location of Fuses, Current Leads, Connectors, Mounting Screws

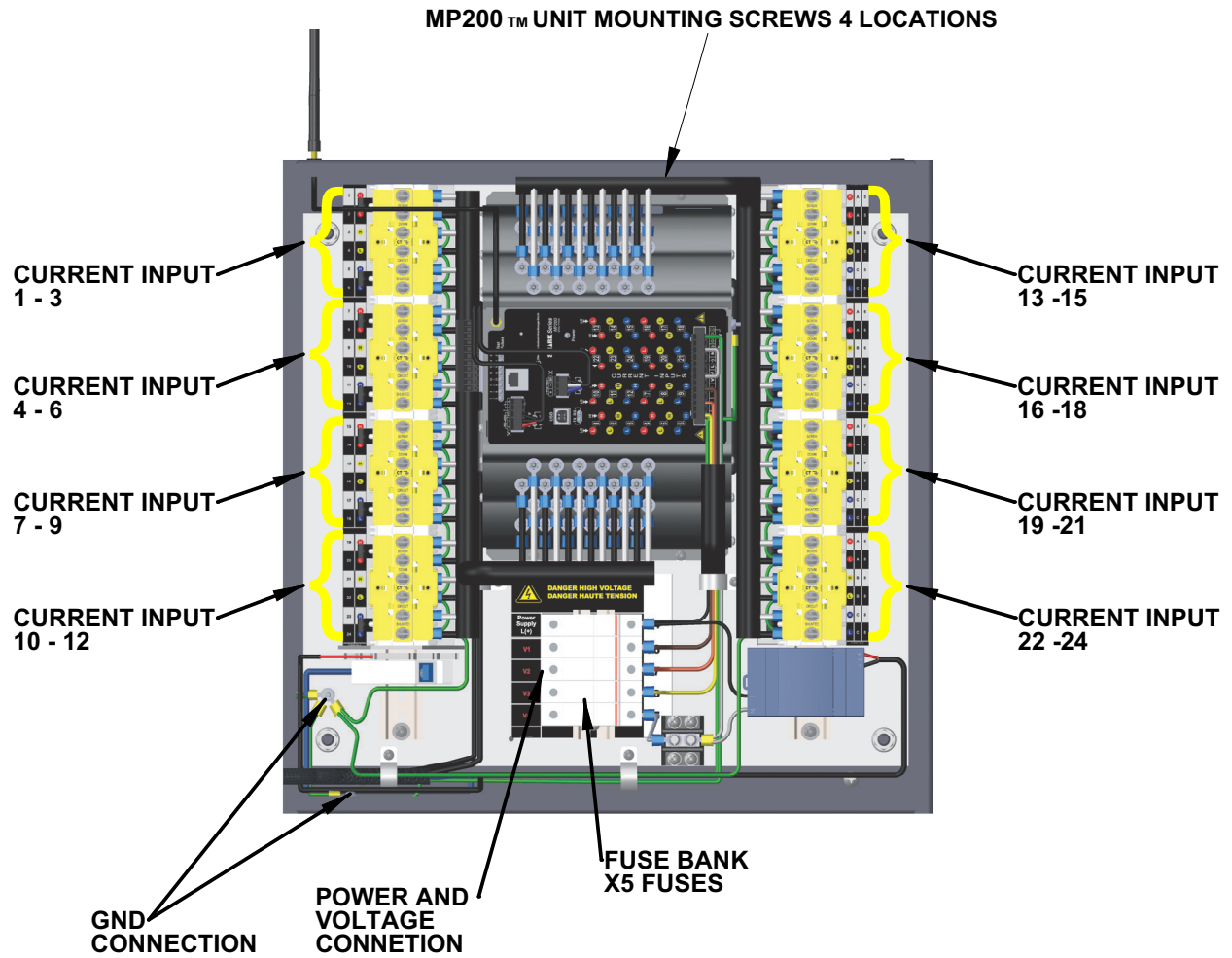

Figure A.4: MP200-S in Enclosure Location of Fuses, Current Leads, Connectors, Mounting Screws

4. Remove the 4 fuses from the fuse block.
5. Un-screw and disconnect the 48 current leads to the meter.
6. Disconnect all connectors to the meter.
7. Remove the 4 mounting screws securing the MP200™ to the panel.
8. Remove the meter.

A.2: Reinstalling the Meter

Follow this procedure to reinstall the meter:

1. Place meter in its location on the panel.
2. Tighten the 4 mounting screws.
3. Insert all connectors into the appropriate sockets on the meter.
4. Connect the 48 current leads to the meter making sure they are attached in the proper order.
5. Install the 5 fuses in the fuse block in their proper location.
6. Unscrew all shorting screws on the CT connection block. See the figure below.

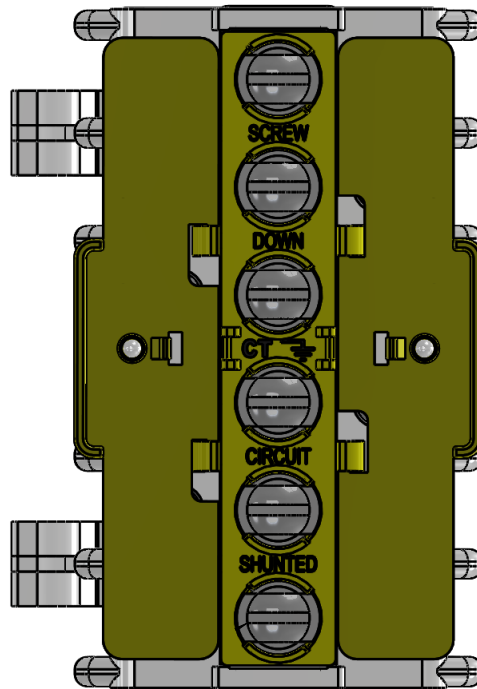

TURN SCREWS COUNTER-
CLOCKWISE TO UNSHORT THE CT

Figure A.5: Un-shorting the CTs

7. Verify that no foreign material remains inside the enclosure: clean it out if found.
8. Energize all circuits and verify operation.